

# 99256

## Dimensions

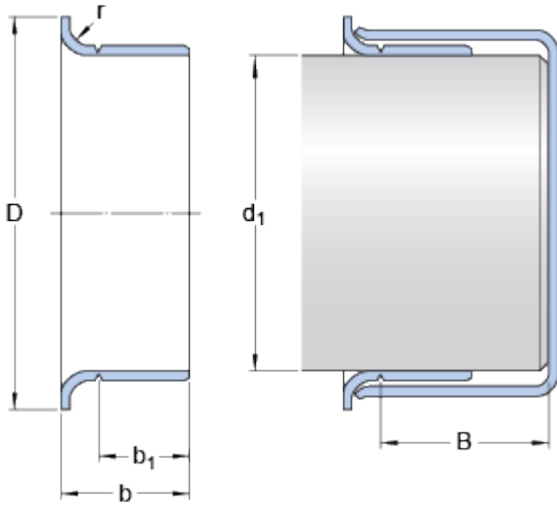

### Nominal dimensions

$d_1$		65.1	mm
$D$		73.431	mm
Tolerance outside diameter $D$	$\pm$	1.6	mm
$b$		23.825	mm
Tolerance width $b$	$\pm$	0.8	mm
$b_1$		19.837	mm
Tolerance width $b_1$	$\pm$	0.8	mm
$B$	max.	34.925	mm
$r$	max.	3.18	mm

### Shaft diameter range

$d_1$	min.	65.024	mm
$d_1$	max.	65.202	mm